

ELECTRIC POWER STEERING OIL PUMP (LF) REMOVAL/INSTALLATION

B3E061432650W02

1. Remove the under cover, splash shield and mudguard.
2. Remove the washer tank. (See [WASHER TANK REMOVAL/INSTALLATION](#).)
3. Remove in the order indicated in the table.
4. Install in the reverse order of removal.

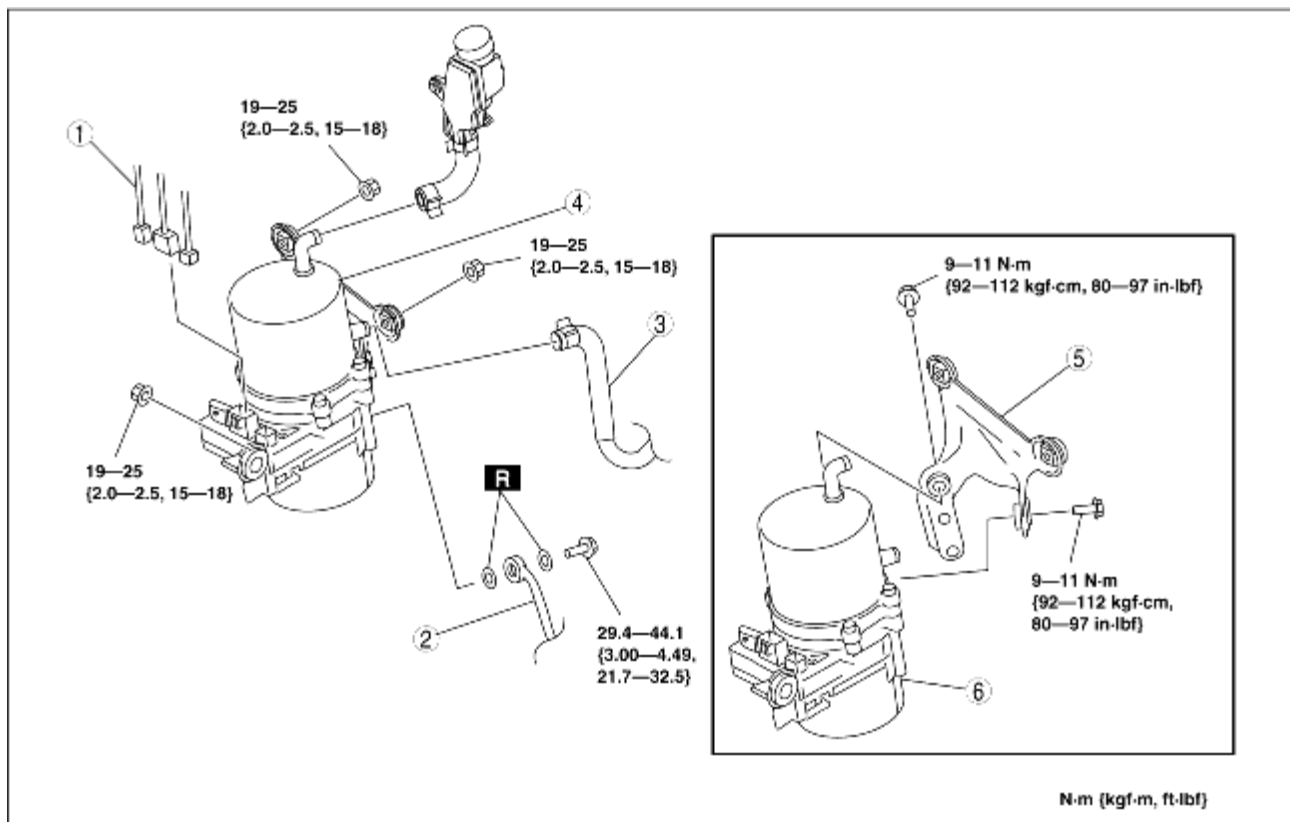

C3U0614W013

1	Connector
2	Pressure pipe
3	Suction hose
4	Electric power steering oil pump and bracket component
5	Bracket
6	Electric power steering oil pump